

Optional Anti-Clog Attachment

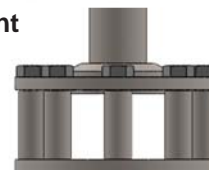

Sensing Element: Piezoresistive Silicon Chip

The PTL pressure transducer is a heavy duty constructed design suitable for many applications for wells, reservoirs, lakes, rivers, sewage treatment plants, water tanks, ground water monitoring and surface water monitoring.

ELECTRICAL:

OUTPUT:
4 - 20 mA
0-5V
0-10V
1-5V
0.5 - 4.5 V

SUPPLY:
10 - 36 VDC(2 wire)
10 - 36 VDC(3 wire)
10 - 36 VDC(3 wire)
10 - 36 VDC(3 wire)
5 VDC (3 wire)

ACCURACY:

± 0.5% Full Scale

INSULATION:

200mΩ/250VDC

PROTECTION:

IP68 with Cable

RESPONSE TIME:

≤1 Millisecond (Up to 90%FS)

MATERIAL:

Sensing Element: Piezoresistive Silicon Chip
Body: 304 Stainless Steel

PRESSURE RANGE:

0 - 285 PSI (0 - 20 BAR)

STORAGE TEMPERATURE:

-40° - 257°F (-40° - 125°C)

OPERATE TEMPERATURE

-4° to 185°F (-20° to 85°C)

OVERLOAD PRESSURE:

1.5 times Full Scan

ORDERING INFORMATION

PTL	- A	- 0/5	- 4M	- C	- AC*	- 80 *
Model	Type	Pressure Range	Connection	Terminal	Options	Pin Out
PTL	A: 4 - 20 mA (2 wire) B: 0 - 5V (3 wire) C: 0 - 10V (3 wire) D: 0.5 - 4.5V (3 wire) E: 1-5V (3 wire)	Specify Pressure Range Required <i>Note: Standard Ranges</i> 0/5 PSI, 0/10 PSI, 0/145 PSI, 0/285 PSI Consult Factory for Other Ranges	4M - 1/4" NPT 4S - 7/16 X 20 SAE Male 4G - 1/4" BSPP* T - Submersible * Non-standard	C- Cable (Specify Cable Length, Min:3ft)	AC - Anti-Clog Attachment	* Advise your required Pin Out, Refer to Page 48 other Pin Out Options