

Circular Overmold Wet-Mate Underwater Connector

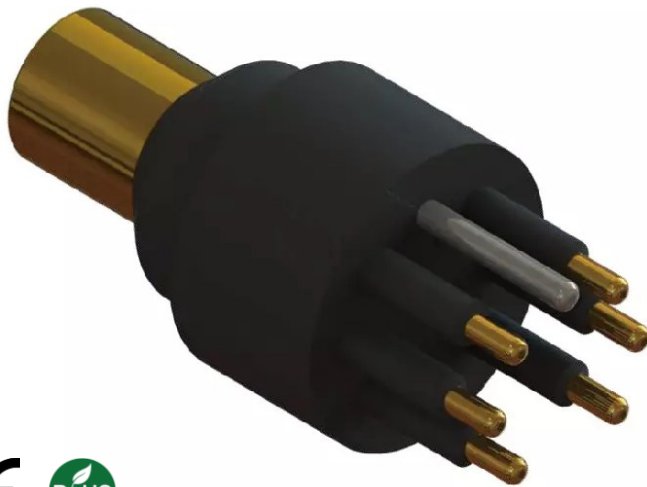

The PSE230 is a rugged, subsea overmolded connector designed for reliable power and stable signal transmission to underwater instruments in harsh marine environments. Built around a durable rubber contact face with rubber or metal body options, the PSE230 is intended for dependable field integration and can be safely connected/disconnected underwater with power turned off, with cable assembly services available to simplify deployment. Typical applications include underwater cameras and lighting/video systems, diver communications, ROV systems, submersibles, towed-array cable systems, current meters, and marine research instrumentation.

Build Your Part Number

Example: PSE230F8C1200

Series	
PSE230	

Type - select one	
M	Male
F	Female

Contacts - select one (view specs on pages 2-5)	
1C	1 Contacts
2C	2 Contacts
3C	3 Contacts
4C	4 Contacts
5C	5 Contacts
6C	6 Contacts
8C	8 Contacts
10C	10 Contacts
12C	12 Contacts
16C	16 Contacts

Cable Length – specify in feet	
XX	Cable length in feet (ex. 1200 feet = 1200)

Note: Cabling, contacts, and connector configuration can be customized per customer specification

1 Contact



Operation Specification

Max. voltage	600 V DC
Current rating @contact	10A
Insulation resistance	>200 Mohm
Contact resistance	<0.01 ohm
Depth rating	600 bar
Temperature rating	-40 to 60 °C

Material Specification

Connector body	Chloroprene rubber
Contact	Gold plated brass
Socket	Gold plated beryllium copper

Dimensions are in millimeters; Threads are in inches

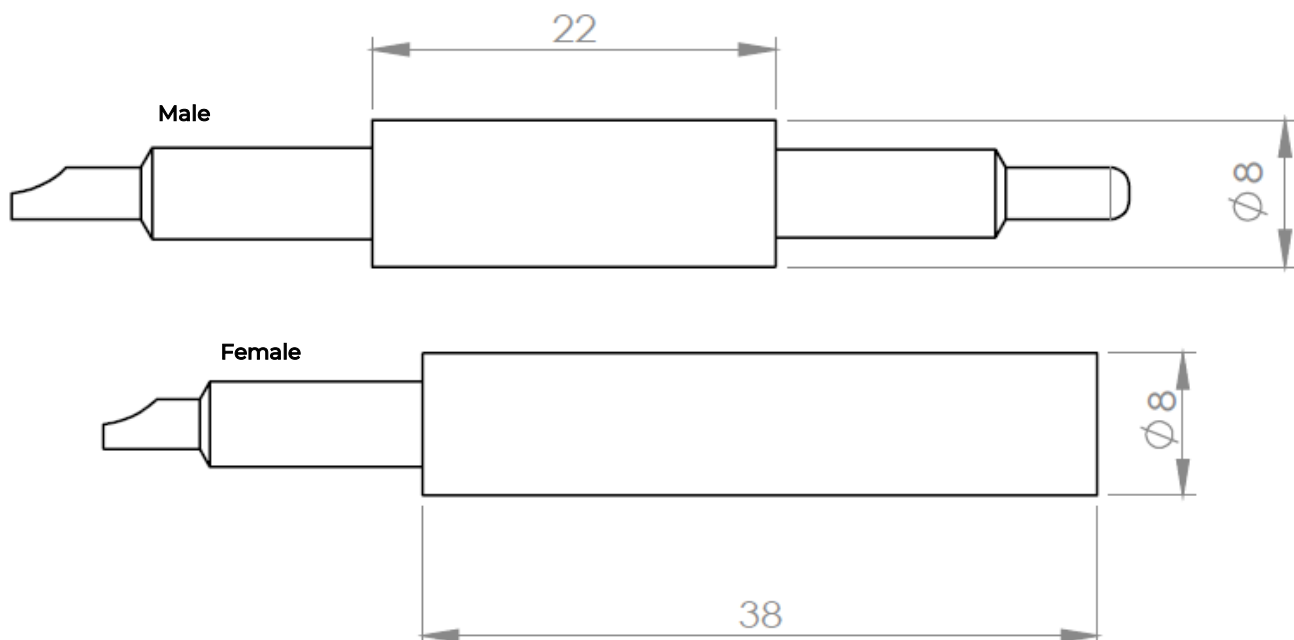

2, 3, 4, and 5 Contacts



Operation Specification	
Max. voltage	600 V DC
Current rating @contact	10A
Max. current @connector	Contact 2: 20A
	Contact 3,4,5: 30A
Insulation resistance	>200 Mohm
Contact resistance	<0.01 ohm
Depth rating	600 bar
Temperature rating	-40 to 60°C

Material Specification	
Connector body	Chloroprene rubber
OM body	Brass(BR)
Contact	Gold plated brass
Socket	Gold plated beryllium copper
Location pin	Contact 2,3,4: Stainless steel 316
	Contact 5: N/A
OM leads	AWG 18 PTFE, 10cm

Dimensions are in millimeters; Threads are in inches

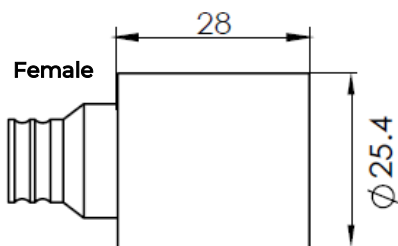
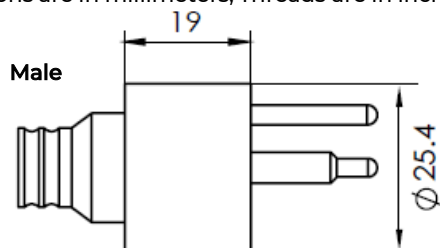

Face View (Male)



Wiring Color Code

- 1 Black
- 2 White
- 3 Red
- 4 Green
- 5 Orange

(3 Conductor code: 1 Black, 2 White, 3 Green)

6, 8, and 10 Contacts

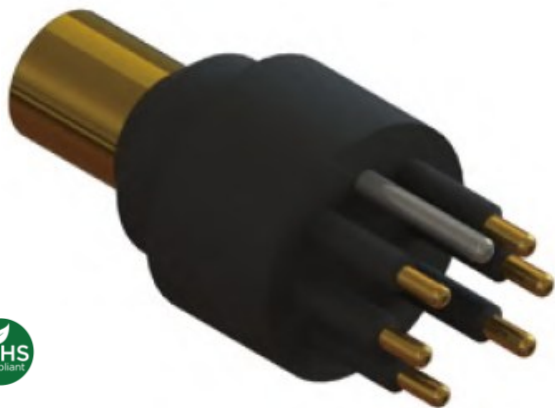

Operation Specification	
Max. voltage	600 V DC
Current rating @contact	10A
Max. current @connector	50A
Insulation resistance	>200 Mohm
Contact resistance	<0.01 ohm
Depth rating	600 bar
Temperature rating	-40 to 60°C

Material Specification	
Connector body	Chloroprene rubber
OM body	Brass(BR)
Contact	Gold plated brass
Socket	Gold plated beryllium copper
Location pin	Contact 6: Stainless steel 316
	Contact 8,10: N/A
OM leads	AWG 18 PTFE, 10cm

Dimensions are in millimeters; Threads are in inches

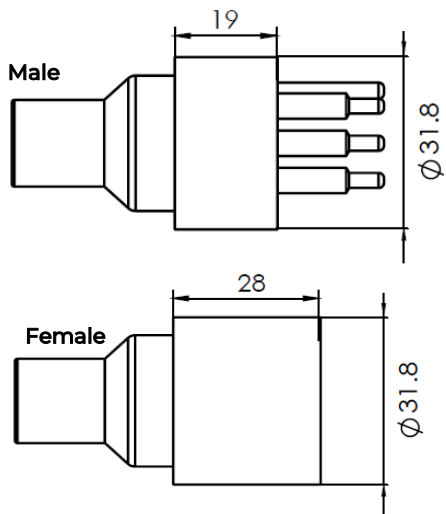

Face View (Male)

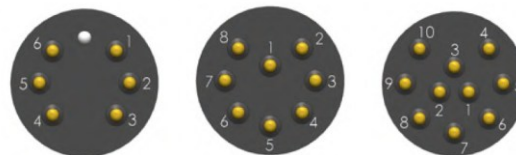

Wiring Color Code

- | | | | |
|---------|----------|---------------|-----------------|
| 1 Black | 4 Green | 7 White/black | 10 Orange/black |
| 2 White | 5 Orange | 8 Red/black | |
| 3 Red | 6 Blue | 9 Green/black | |

12 and 16 Contacts

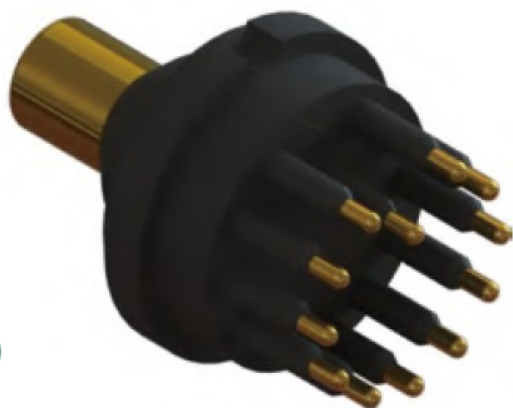

Operation Specification	
Max. voltage	600 V DC
Current rating @contact	10A
Max. current @connector	60A
Insulation resistance	>200 Mohm
Contact resistance	<0.01 ohm
Depth rating	600 bar
Temperature rating	-40 to 60°C

Material Specification	
Connector body	Chloroprene rubber
OM body	Brass(BR)
Contact	Gold plated brass
Socket	Gold plated beryllium copper
OM leads	AWG 18 PTFE, 10cm

Dimensions are in millimeters; Threads are in inches

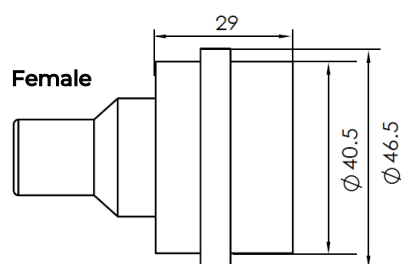
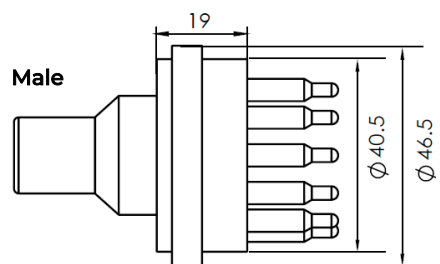

Face View (Male)



Wiring Color Code

- | | | |
|-----------------|----------------|---------------|
| 1 Black | 4 Green | 7 White/black |
| 2 White | 5 Orange | 8 Red/black |
| 3 Red | 6 Blue | 9 Green/black |
| 10 Orange/black | 13 Red/white | 16 Black/red |
| 11 Blue/black | 14 Green/white | |
| 12 Black/white | 15 Blue/white | |