

Overview

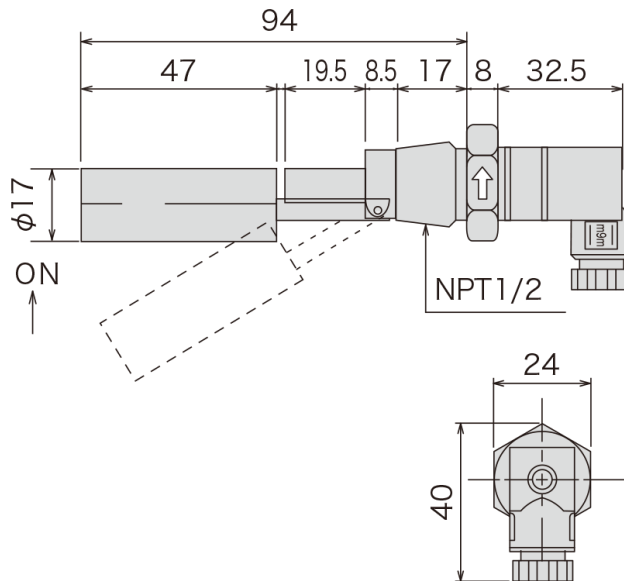
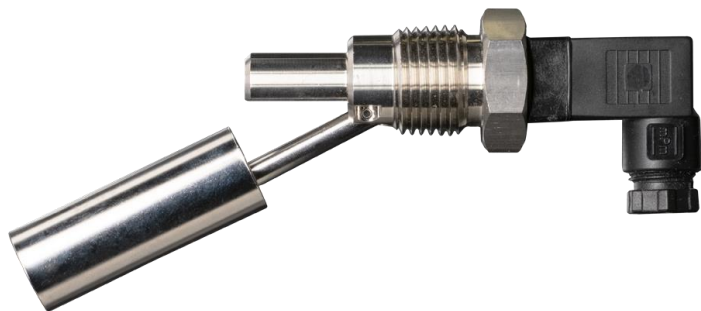

Description

The P294 is a side-mounted, stainless-steel float-type level switch designed for reliable liquid level detection in various industrial applications. Its robust construction and compatibility with water, oil, and chemical solutions make it a versatile choice for monitoring liquid levels in diverse environments.

Technical Parameters

Material	Stem	SUS304
	Float	SUS304
	Stopper	SUS304
	Nat	SUS304
Specifications	Temperature Range (Atmospheric)	-40°C~+120°C
	Pressure Resistance (Room Temperature)	0.5MPa
	Float Specific Gravity	0.7±0.05
Electric Specs	Maximum Contact Capacity	50W DC/AC
	Maximum Voltage	300V DC/AC
	Maximum Current	0.5A DC/AC
	Wire Length	300mm Standard (Custom lengths available)