

Cylindrical Threaded Reed Proximity Switch M8 x 0.75

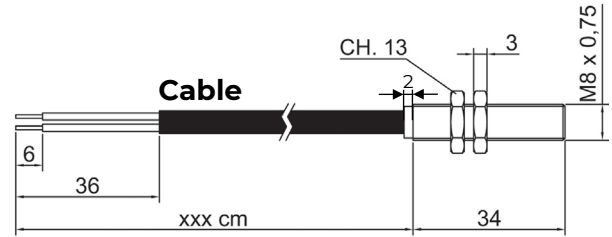

0703**

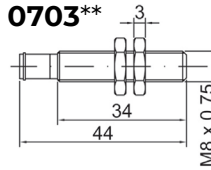

1703***

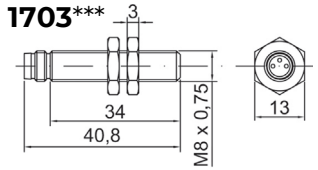

Series

P238

Switching Function - select one*

	Contact Type	Voltage		Power	Current	Cable	Diameter	Conductors	Cable Type	Connection Scheme
		DC	AC							
A1	Normally open	100 V Max	150 V Max	10W Max	0.5 A Max	UE	4.8 mm	2 x AWG24	Black Bipolar	
A2	Normally open	200 V Max	250 V Max	50 W Max	1 A Max	UM	5.1 mm	2 x AWG22		
B1	Normally open X 2	100 V Max	125 V Max	10 W Max	0.5 A Max	UE	4.8 mm	2 x AWG24	Black Bipolar	
B2	Normally open X 2	100 V Max	125 V Max	10 W Max	0.5 A Max	UM	5.1 mm	2 x AWG22		
F1	Normally closed	150 V Max		10 W Max	0.5 A Max	UE	4.8 mm	2 x AWG24	Black Bipolar	
L1	Change Over	150 V Max		10 W Max	0.5 A Max	TU	4.9 mm	3 x AWG24	Black Tripolar	

*Voltage and amperage can be configured to meet project requirements as long as they remain within the device's operational range and do not exceed the specified maximum wattage.

Electrical Termination - select one

E1	Flying leads
E2	With round pins
E3	With faston 6.3mm sockets
E4	With faston 6.3mm x 0.8mm tabs
E5	Connector 0703**
E6	Connector 1703***

Working Temperature - select one

N	Normal = -4°F to 140°F (-20°C to 60°C)
H	High Temp = -4°F to 194°F (-20°C to 90°C)

Cable Length - select one

xxx	Please specify in cm (Ex: 25)
-----	-------------------------------

Technical Parameters

Electrical	Operating Frequency	250 imp/sec
Mechanical	Housing Material	Brass Nickel Plated
	Process Connection	Threaded M8x0.75
	Mechanical Life	100,000,000 cycles
	Repeatability at 77°F	0.1 mm
Environmental	Impact Resistance	30 g / 11 ms
	Vibration Resistance	0.35 mm, 10-55 Hz