

Overview

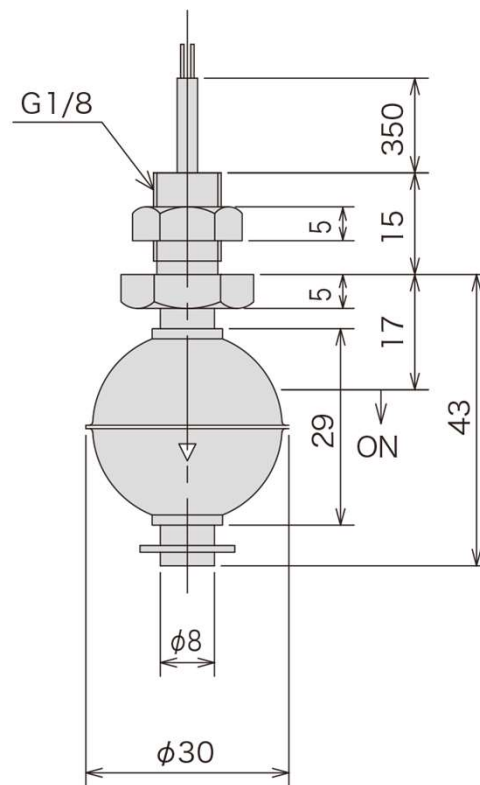

Description

The P196 is a compact, stainless-steel float-type level switch designed for high-pressure applications, accommodating up to 2 MPa (290 psi) and temperatures ranging from -40 °C to 120 °C (-40 °F to 248 °F). Its robust construction and compatibility with various liquids make it ideal for precise level detection in demanding industrial environments.

Technical Parameters

Material	Stem	SUS304 (316)
	Float	SUS304 (316L)
	Stopper	SUS304 (316)
	Nat	SUS304 (316)
Specifications	Temperature Range (Atmospheric)	-40°C~+120°C
	Pressure Resistance (Room Temperature)	2MPa
	Float Specific Gravity	0.7±0.1
Electric Specs	Maximum Contact Capacity	50W DC/AC
	Maximum Voltage	300V DC/AC
	Maximum Current	0.5A DC/AC
	Wire Length	300mm Standard (Custom lengths available)