

# Overview

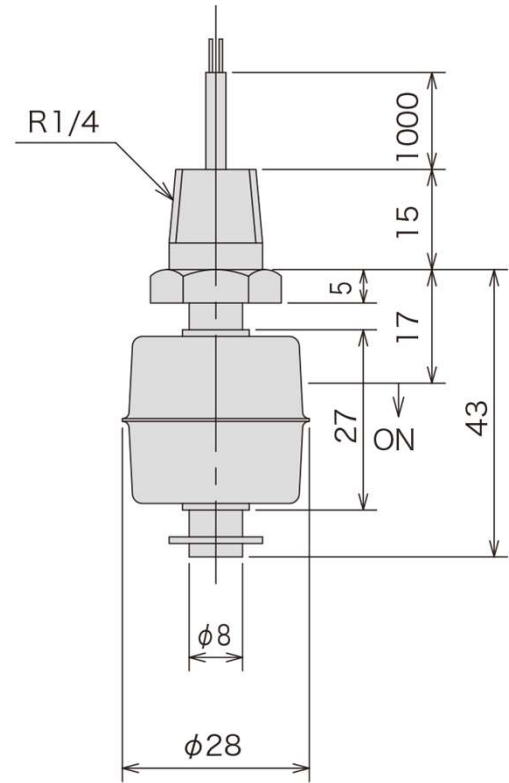

## Description

The P195 is a compact, stainless-steel float-type level switch designed for precise liquid level detection in various industrial applications. Its robust construction and high resistance to oil and chemicals make it suitable for demanding environments.

## Technical Parameters

<b>Material</b>	Stem	SUS304 (316)
	Float	SUS304 (316L)
	Stopper	SUS304 (316)
	Nat	SUS304 (316)
<b>Specifications</b>	Temperature Range (Atmospheric)	-40°C~+120°C
	Pressure Resistance (Room Temperature)	1MPa
	Float Specific Gravity	0.7±0.05
<b>Electric Specs</b>	Maximum Contact Capacity	50W DC/AC
	Maximum Voltage	300V DC/AC
	Maximum Current	0.5A DC/AC
	Wire Length	300mm Standard (Custom lengths available)